

## Valve Regulated Lead Acid Batteries, AGM Technology

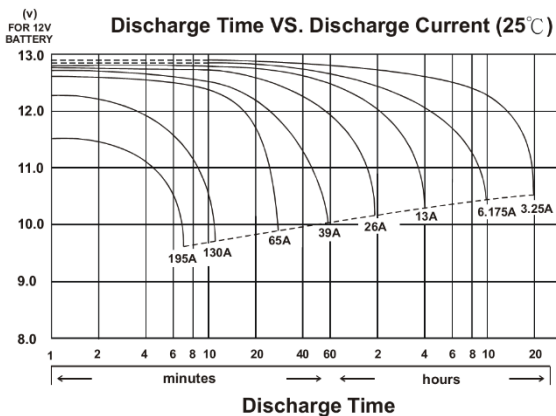

**F8 (M6 Bolt)**

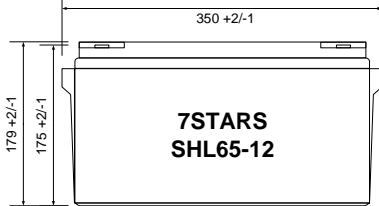
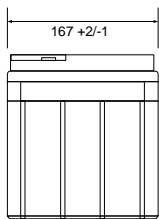
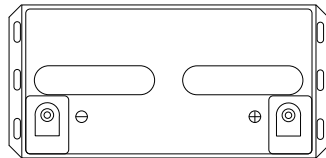
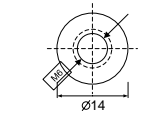

**Constant Power Discharge Characteristics (25°C) [Watt]**

Cut Off V	Time										
	5 min.	10 min.	15 min.	30 min.	1 hour	2 hours	3 hours	4 hours	5 hours	10 hours	20 hours
11.1	2412	1765	1386	866	460	309	213	171	143	82.0	42.2
10.8	2580	1861	1440	885	467	314	216	174	145	83.0	42.9
10.5	2742	1941	1487	902	472	318	219	176	146	83.6	43.6
10.2	2892	2019	1526	917	478	323	221	178	148	84.2	44.2
9.90	2970	2059	1551	925	481	324	223	180	149	85.4	44.6
9.60	3151	2144	1599	943	487	330	225	182	151	86.5	45.4

Due to continual product improvement, the design and specifications are subject to change without prior notice.

### SPECIFICATION

<b>Nominal Voltage (V)</b>	12V
<b>Nominal Capacity</b>	
20 hour rate	65Ah
10 hour rate	61.75Ah
5 hour rate	55.25Ah
1C	41.17Ah
3C	26Ah
<b>Weight</b>	21.5kg
<b>Internal Resistance</b>	7mΩ @ 1kHz
<b>Maximum Discharge Current for</b>	
5 sec.	780A
<b>Operating Temperature Range</b>	
Charge	0°C ÷ 40°C
Discharge	-15°C ÷ 50°C
Storage	-15°C ÷ 40°C
<b>Charge Retention (shelf life) at 20°C</b>	
1 month	92%
3 month	90%
6 month	80%
<b>Charging Methods at 20°C</b>	
Max. Charging Current	19.5A
<b>Cycle use:</b>	
Charging Voltage	14.4 ÷ 15.0V
Thermal Coefficient	-5.0mV/°C/cell
<b>Standby use:</b>	
Float Charging Voltage	13.50 ÷ 13.80V
Thermal Coefficient	-3.0mV/°C/cell
<b>Life expectancy</b>	
<b>Cycle Use</b>	
100% depth of discharge	200 cycles
80% depth of discharge	225 cycles
50% depth of discharge	500 cycles
<b>Standby Use</b>	12 years (Eurobat)
<b>Case Material</b>	ABS
<b>Terminal</b>	F8 (M6 Bolt)
Recommended torque value	7Nm
Maximum torque value	9Nm